

Thank you for purchasing Sullivans Add-A-Table, please note that there is NO ASSEMBLY required, your Add-A-Table is ready to use out of the box, the following guidelines are simply to help you set up your table for regular use and also show how to connect more Add-A-Tables (sold separately).

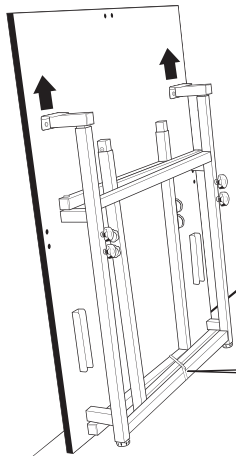

1. Remove **Add-A-Table** from packaging and rest it on a flat wall with both hinges facing up as shown.

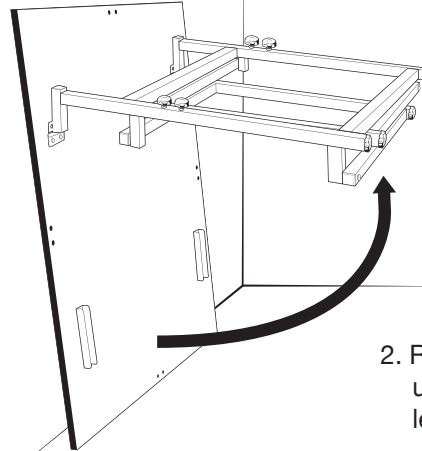
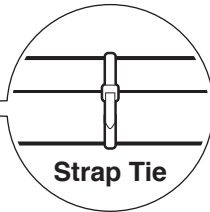

2. Remove **Strap Tie** and lift up the left and right table legs as shown.

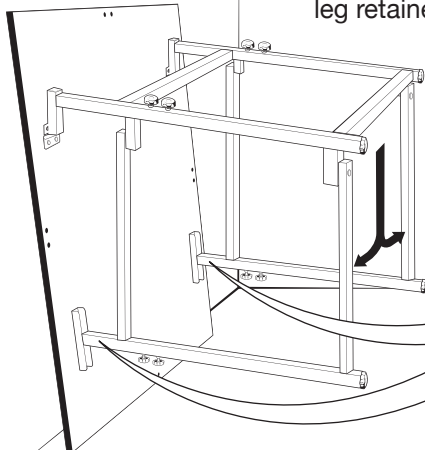

3. Fold out the left and right legs and place them into their respective leg retainers as shown.

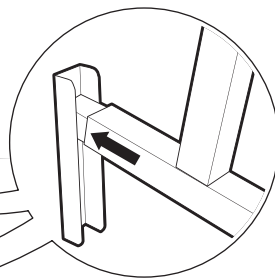

4. Adjust the Table's Height and Angle as desired.

**Please note:** When raising the table, raise the back legs first, then the front. When lowering the table, lower the front legs first, then the back.

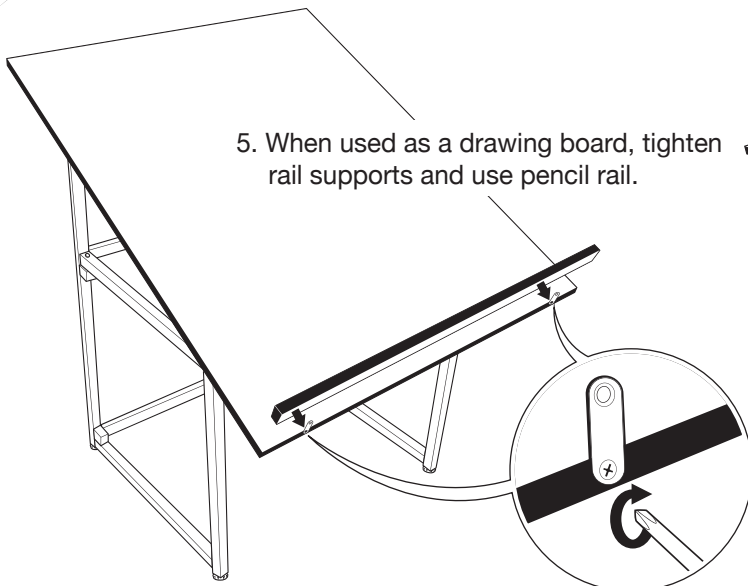
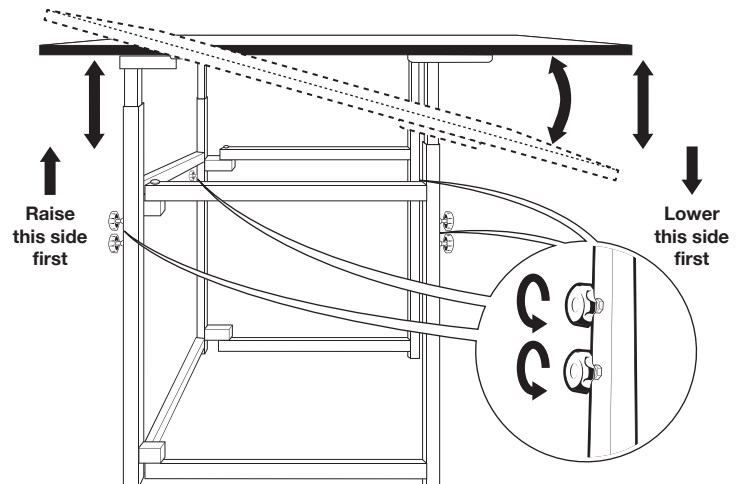

5. When used as a drawing board, tighten rail supports and use pencil rail.

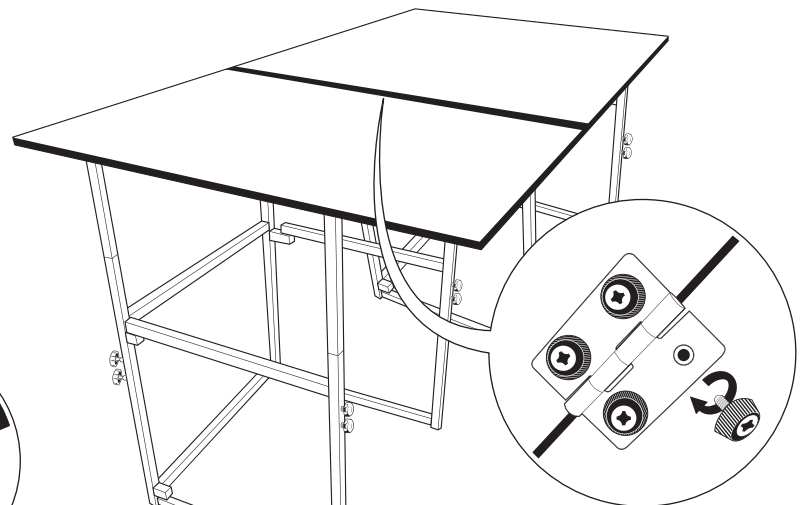
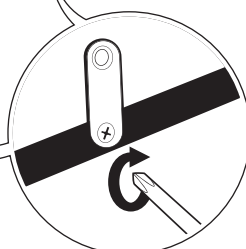

6. Use the included joining plate and screws to join 2 or more ADD-A-TABLES together.

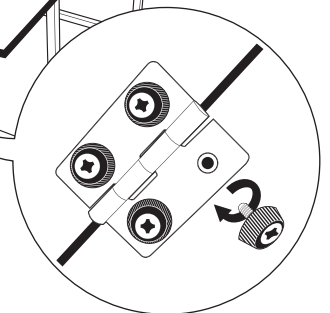



# Adjustable ADD-A-TABLE

Item No. 39271

**SAFETY AND MAINTENANCE: DO NOT** allow children to play on, under or around this table. To clean use a cloth or sponge and some mild detergent. **DO NOT USE** any abrasive pads or cleaners.

— **DO NOT RETURN TO STORE** —

Sullivan's will replace any missing manufacturing or defective parts within 30 days of purchase.

Send a dated receipt copy to (630) 435-1532 (Fax) or [Sulnotions@sbcglobal.net](mailto:Sulnotions@sbcglobal.net)

**THIS DOES NOT APPLY TO SHIPPING DAMAGES.**

For further assistance please call our toll free number (800) 862-8586 or e-mail [Sulnotions@sbcglobal.net](mailto:Sulnotions@sbcglobal.net)

**PLEASE NOTE:** Our 30-day No Charge replacement policy for parts does not apply to items sold AS IS, CLEARANCE, CLOSEOUT, FINAL SALE, ETC.

Any parts requested under these circumstances will be charged to the customer, including shipping charges.

Shipping charges for replacement parts to Alaska, Hawaii or any point outside of The Contiguous United States are not covered under our policy.

Some restrictions apply. See website for details.

## Sullivan's USA

4341 Middaugh Avenue, Downers Grove, IL 60515

Toll Free: (800) 862-8586 • Fax: (630) 435-1532

## Table Accessories

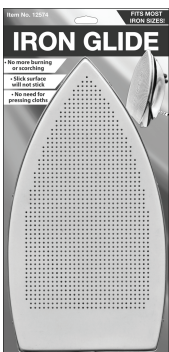

**Iron Glide**  
Item No. 12574



**Cord Minder**  
Item No. 12710



**Ironing Cover**  
Item No. 12594



**Heat Resistant Ironing Cover**  
Item No. 12572



**Scrap Caddy**  
Item No. 12573

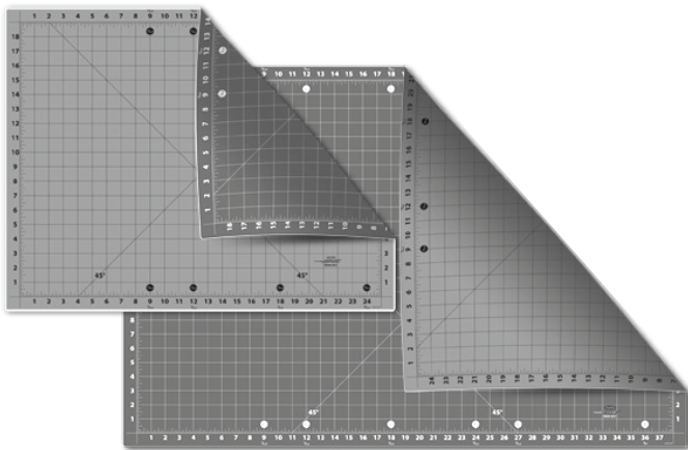

**EDGE Cutting Mats**  
**Double Sided**  
18" x 24" - 38216  
24" x 37" 38217

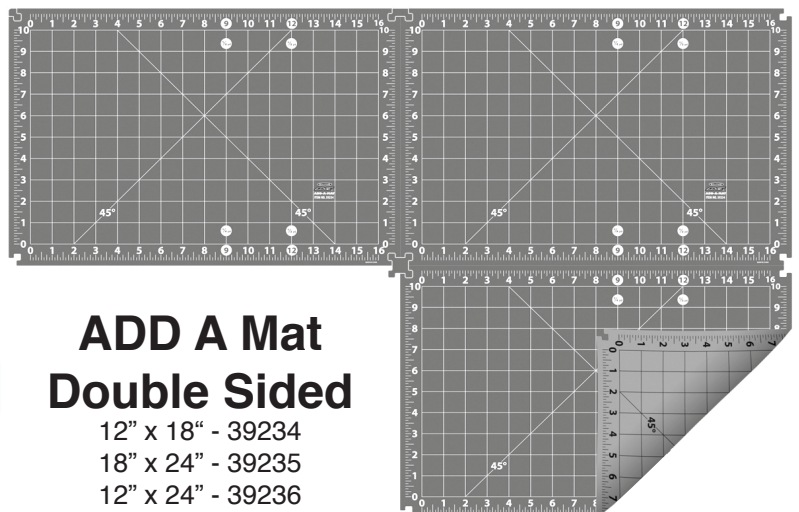

**ADD A Mat**  
**Double Sided**  
12" x 18" - 39234  
18" x 24" - 39235  
12" x 24" - 39236  
Twin Joint (4) - 39232  
Cross Joint (2) - 39233

Available at Fine Fabric and Craft Shops Nationwide, also online at





# **DO NOT RETURN TO THE STORE**

**FOR ASSISTANCE WITH MISSING OR REPLACEMENT  
PARTS, INSTALLATION, OR INFORMATION**



[www.sullivansusa.net](http://www.sullivansusa.net)

**PLEASE CALL US AT**  
**800.862.8586**



[www.sullivansusa.net](http://www.sullivansusa.net)

Sullivan's USA, Inc. will replace any missing or defective parts within 30 days of purchase. Fax a dated receipt with your contact information, the lot number on your instructions, and your request to **630-435-1532** or e-mail to **Sullivans@SullivansUSA.net**. To expedite this process, include any parts you may need in your request. This policy does not apply to damages due to shipping. For further assistance, please call 800-862-8586.

Please note that the no-charge Replacement Policy does not apply to items sold as is, clearance, closeout, final sale, etc. Any parts requested under these circumstances will be charged to the customer, including shipping charges. Shipping charges for replacement parts to Alaska, Hawaii or any point outside of the Contiguous United States are not covered under our policy. Some restrictions apply. See website for details. If you are outside of the 30 day period, replacement parts are available for purchase.

**4341 MIDDAUGH AVENUE • DOWNERS GROVE, IL 60515 • ORDERS: 800.862.8586 • FAX: 630.435.1532**